



# EASY GLASS<sup>®</sup> UP

THE GLASS RAILING FOR  
PARAPET WALLS

## Clear views from any area enclosed by parapet walls

The Easy Glass® Up base shoe is ultra-slim at only 80 mm high.

- Light and medium use railings for indoor and outdoor parapet walls
- Compatible with glass infills up to 700 mm high
- Convenient installation from inside the railing
- Quick and easy glass mounting with the unique Safety Wedge System (wedges and rubber set)
- Can be combined with:
  - Q-railing's glass mounted handrails, cap rails, U-profiles and edge protection
  - Q-glass (glass infill – custom made or from stock)
  - Q-lights Linear Light (for LED-lit handrails and cap rails)



Easy Glass® Up	UK	DE	NL	IT	CH	ES	FR
Max. line load (kN/m)	0,74	1,0	0,8	2,0	1,6	1,6	1,0

Please refer to the respective certificates for specifications such as mounting details and glass dimensions. For more information, please visit our website: [www.q-railing.com/certificates](http://www.q-railing.com/certificates)

Easy Glass® Up is designed for mounting on parapet walls.

### EASY GLASS® UP



#### Up Top mount

- For parapet walls
- Also for embedding in a wall

24

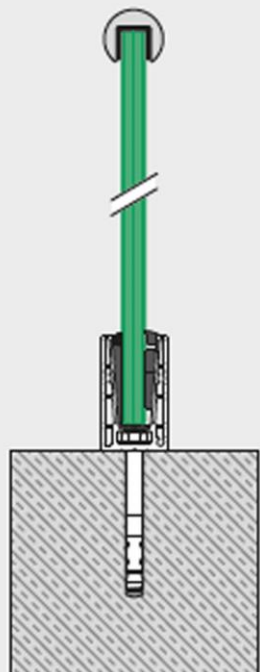

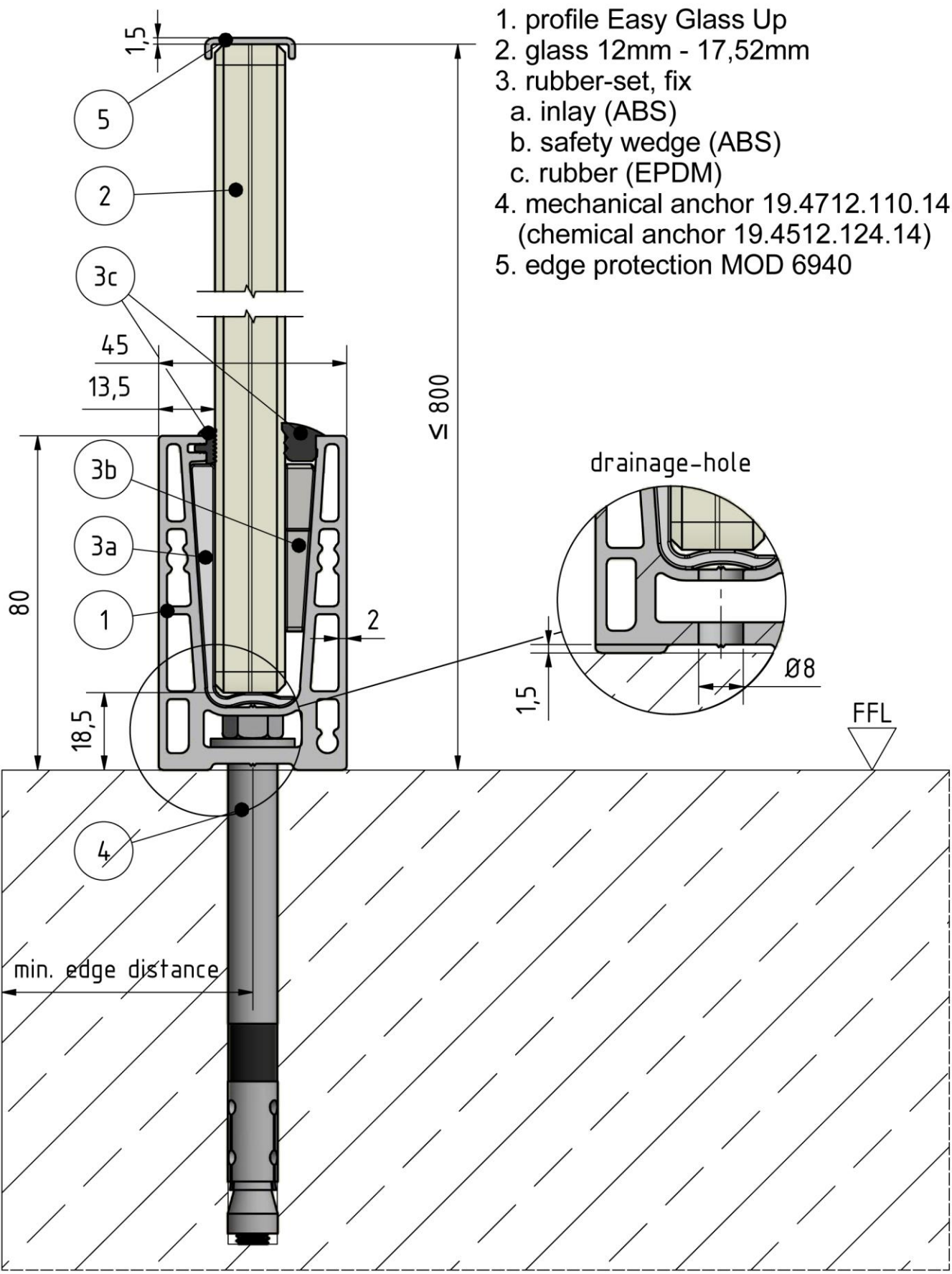

1. profile Easy Glass Up
2. glass 12mm - 17,52mm
3. rubber-set, fix
  - a. inlay (ABS)
  - b. safety wedge (ABS)
  - c. rubber (EPDM)
4. mechanical anchor 19.4712.110.14  
(chemical anchor 19.4512.124.14)
5. edge protection MOD 6940

**SYSTEM:** Easy Glass Up  
**MODEL:** 6924  
**DESCRIPTION:** top mount

**DRAWN:** MPS  
**DATE:** 02.11.2016  
**DRAWING NO.:** 6924-001

This detail drawing is for reference purposes only. The installer must check the specifications and details with the local situation and regulations. For further advice and service please contact your nearest Q-railing office.

© Q-railing Europe GmbH & Co. KG

THE PREMIUM BRAND IN RAILING SYSTEMS | WWW.Q-RAILING.COM

