

# R-ITS-Z Internally Threaded Sockets

High load-bearing capacity

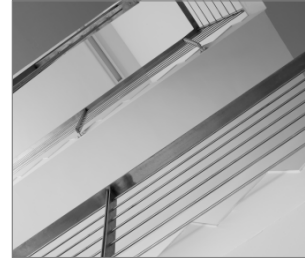
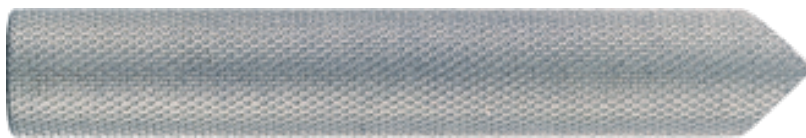

## Product information

### Features and benefits

- Allows removal of bolt to leave a re-usable socket in place
- High load-bearing capacity
- Close edge and spacing distances
- Expansion free functioning
- Available in zinc plated and stainless steel versions

### Applications

- For fastening of threaded rods or bolts
- Safety barriers
- Temporary works/formworks support systems

### Base materials

- Approved for use in:
- Non-cracked concrete C20/25-C50/60

## Installation guide

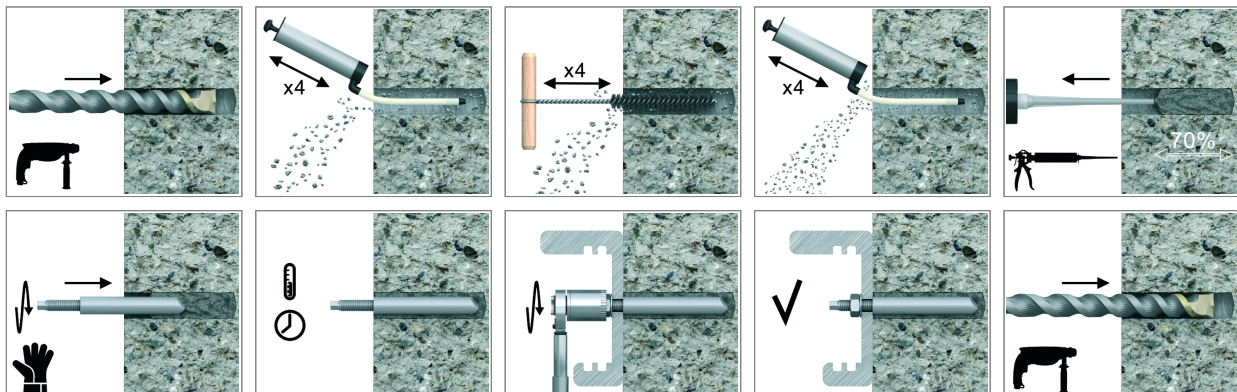

## Product information

1. After injecting resin, immediately insert the socket anchor, slowly and with a slight twisting motion until flush with surface
2. Remove excess resin, then leave anchorage undisturbed until curing time has elapsed
3. After injecting resin, immediately insert the socket anchor, slowly and with a slight twisting motion until flush with surface
4. For installation with a drilling machine, insert the setting tool into socket and spin in using rotary hammer action
5. Remove excess resin, then leave anchorage undisturbed until curing time has elapsed

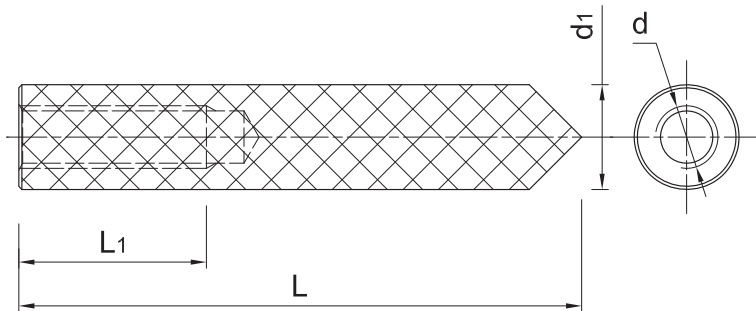

Size	Product Code	Socket diameter	Length	Internal thread length	Max. thickness	Hole diameter	
		[mm]	[mm]	[mm]	[mm]	[mm]	
M6	R-ITS-Z-06075	10	75	24		7	Steel class 5.8
M8	R-ITS-Z-08075	12		90		25	
	R-ITS-Z-08090		30		12		
M10	R-ITS-Z-10075	16	100	35	14		
	R-ITS-Z-10100			50	18		
M12	R-ITS-Z-12100						
M16	R-ITS-Z-16125	24	125	50		18	

## Product commercial data

Size	Product Code	Anchor	Quantity [pcs]			Weight [kg]			Bar Codes
		Length [mm]	Box	Outer	Pallet	Box	Outer	Pallet	
M6	R-ITS-Z-06075	75	10	10	5600	0.40	0.40	254.0	5010445606205
M8	R-ITS-Z-08075	75	10	10	5600	0.65	0.65	394.0	5906675087719
	R-ITS-Z-08090	90	10	10	5600	0.65	0.65	394.0	5010445606236
M10	R-ITS-Z-10075	75	10	10	5600	0.77	0.77	461.2	5010445606243
	R-ITS-Z-10100	100	10	10	3360	1.50	1.50	534.0	5010445606267
M12	R-ITS-Z-12100	100	6	6	2016	0.69	0.69	261.8	5906675087726
M16	R-ITS-Z-16125	125	6	6	2016	2.0	2.0	699.3	5906675087733