

**8201**

**TRILOBA®**



- Cerniera oleodinamica con regolazione delle velocità di chiusura dell'anta. Stop a 0° +90° -90°.
- Bisagra automática hidráulica inferior con regulación de velocidad de cierre de la puerta. Stop a 0°, + 90°, -90°.
- Hydraulic hinge with adjustment of the closing speed of the door. Stop at 0° +90° -90°.
- Automatik-, Hydraulikscharnier mit Regulierung der Türgeschwindigkeit. Feststellung bei 0°+90°-90°.



**APERTURE VIOLENTE OLTRE I 95° POTREBBERO CAUSARE LO SCARDINAMENTO. È CONSIGLIABILE L'APPLICAZIONE DI UN FERMAPORTA - APERTURA VIOLENTA ADEMÁS DE 95°, PODRÍA CAUSAR DAÑO. ACONSEJAMOS UTILIZAR UN FIJA PUERTA. - VIOLENT OPENING FURTHER THAN 95° COULD UNHINGE THE DOOR. WE SUGGEST TO INSTALL A DOOR STOP - HEFTIGE ÖFFNUNGEN MEHR ALS 95° KÖNNTEN DIE TÜR AUSHEBEN. WIR SCHLAGEN DIE INSTALLIERUNG EINES TÜRHALTERS VOR**

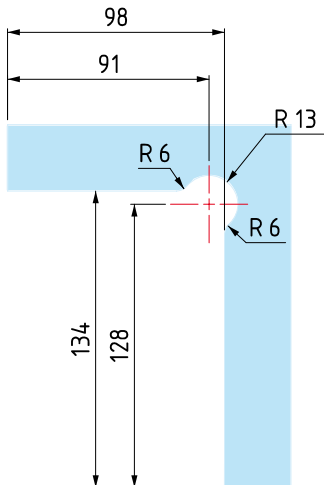
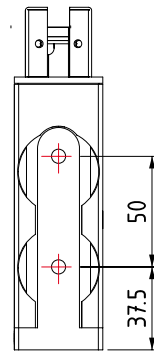
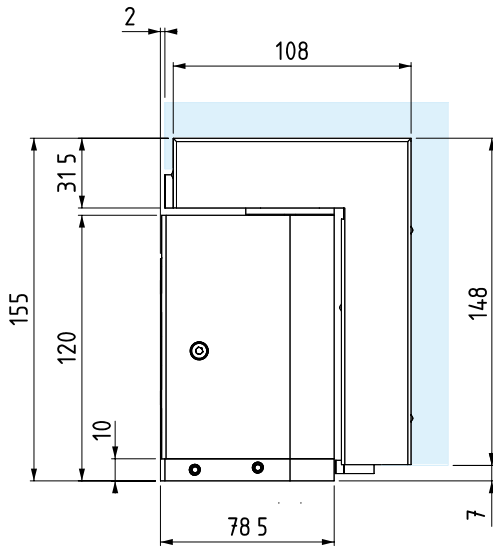
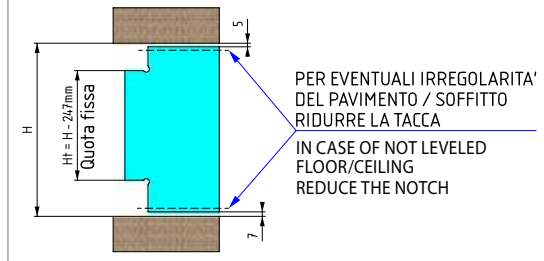
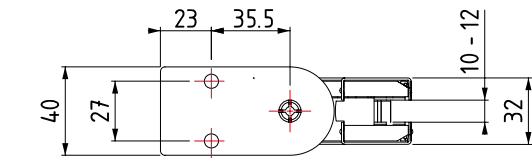

Ugello di regolazione della velocità di chiusura.  
 Válvula de ajuste de la velocidad de cierre de la puerta.  
 Control valve for the closing speed of the door.  
 Regelventil für die Türschließgeschwindigkeit.

Cerniera oleodinamica - Bisagra automática hidráulica - Hydraulic hinge - Hydraulikscharnier