



**C.R. LAURENCE CO., INC.**  
**PROFESSIONAL QUALITY**

## HEAVY DUTY GLASS CLAMPS

90° Glass Clamp  
(Glass-to-Glass Application)

**CAT. No.BGC90**

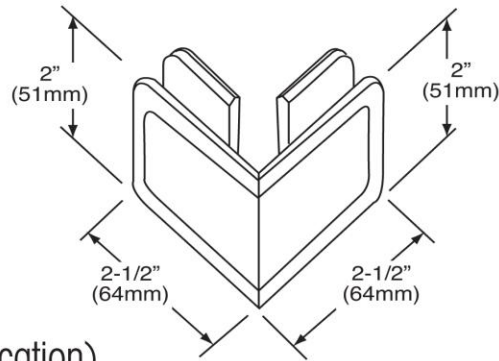

FRONT VIEW

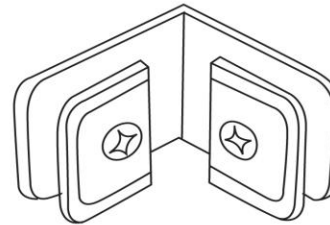

REAR VIEW

## Specifications:

**Material:** Solid brass

**Glass Thickness Range:** 3/8" (10mm) to 1/2" (12mm)

**Hole Size Required:** 3/4" (19mm) or 7/8" (22mm)

(45° Mitered Glass Option)

**Includes:** Mounting screws and gaskets

**Template Shown on Next Page**

## HEAVY DUTY GLASS CLAMPS

90° Glass Clamp  
(Glass-to-Glass Application)

**CAT. No.SGC90**

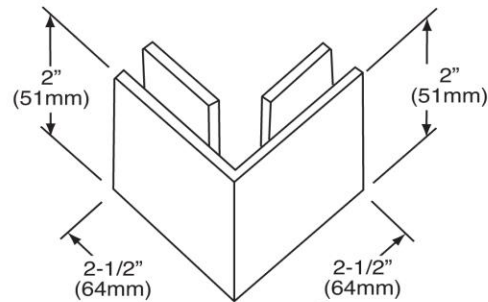

FRONT VIEW

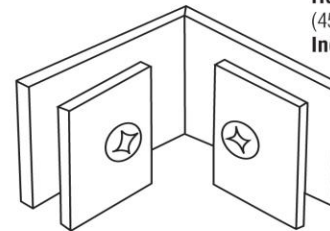

REAR VIEW

## Specifications:

**Material:** Solid brass

**Glass Thickness Range:** 3/8" (10mm) to 1/2" (12mm)

**Hole Size Required:** 3/4" (19mm) or 7/8" (22mm)

(45° Mitered Glass Option)

**Includes:** Mounting screws and gaskets

**Template Shown on Next Page**

## TYPICAL INSTALLATION

**Important:** Project measurements from the edge of the glass

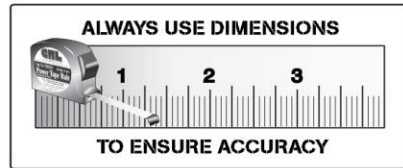
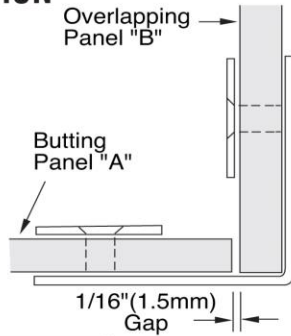

## GLASS CLAMPS

The Template Options on This Page Apply to the Following Clamps:

90° Glass Clamp  
(Glass-to-Glass Application)

**Cat. No. BGC90**

90° Glass Clamp

**Cat. No. SGC90**

C.R. Laurence Co., Inc.  
crlaurence.com

For technical assistance in the United States call toll free (800) 421-6144; from Canada call toll free (877) 421-6144; Outside the U.S. and Canada call (323) 588-1281. Ask for Tech Sales at Extension 7740. Toll free fax (800) 458-7496.

## TEMPLATE OPTION FOR SQUARE CUT GLASS

3/4" (19mm)  
Diameter Hole

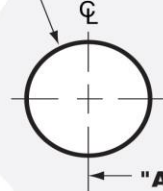

**Glass Panel**

3/4" (19mm)  
Diameter Hole

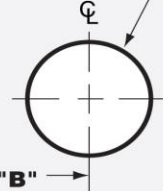

**Glass Panel**

**Glass Thickness**

3/8" (10mm)  
1/2" (12mm)

**"A"\*  
Measurement**

1-3/16" (30mm)  
1-1/16" (27mm)

**"B"\*  
Measurement**

1-5/8" (41mm)  
1-5/8" (41mm)

## TYPICAL INSTALLATION

**Important:**  
Project measurements from the outside of the mitered glass.

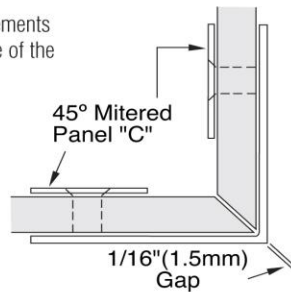

**Glass Thickness**

3/8" (10mm)  
1/2" (12mm)

**"C"\*  
Measurement**

1-1/2" (38mm)  
1-1/2" (38mm)

## TEMPLATE OPTION FOR 45° MITERED GLASS

7/8" (22mm)  
Diameter Hole

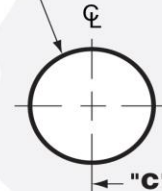

**Glass Panel**

7/8" (22mm)  
Diameter Hole

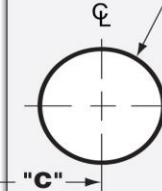

**Glass Panel**

**Outside Edge of Miter**

\*From the Outside Edge of Miter