



THE WHOLESALE GLASS CO.

Threaded Insert for Timber Fitting

Installation Guide

Threaded insert requires a pilot hole in the timber, can be secured using an Allen key or socket wrench.

M8 & M10 Threaded Insert for Timber Fitting - Zinc Alloy - requires a 12mm pilot hole in the timber.
M10 Threaded Insert for Timber Fitting - Zinc Plated Steel - requires a 16mm pilot hole in the timber.

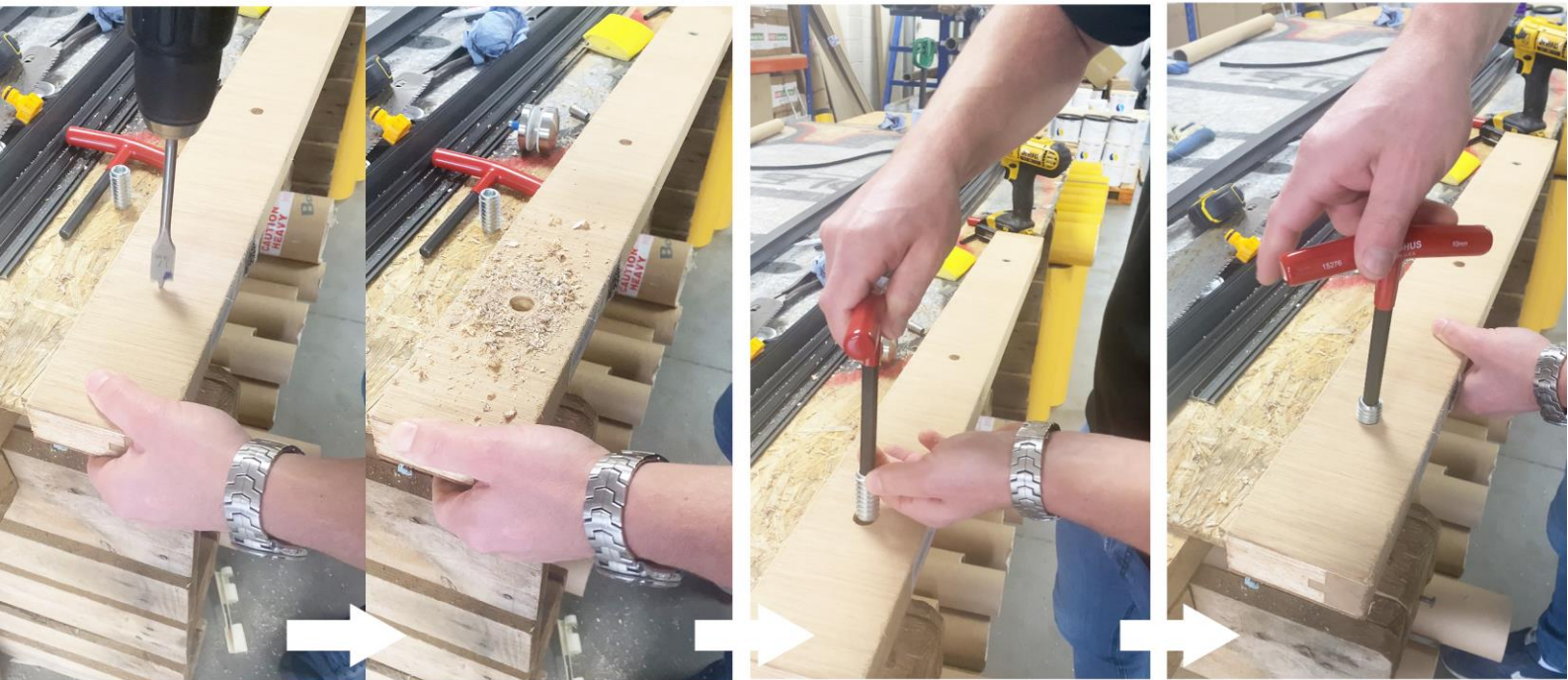

Secure using a 10mm hex (allen) key or socket wrench.



Threaded Insert for Timber



Hex (Allen) keys are available to purchase separately.